



Scott Matties

AIA LEED-AP
Executive Vice President + Studio Director

EDUCATION:

Master of Architecture,
University of Michigan, 1990
Bachelor of Science, Architecture,
University of Michigan, 1988

REGISTRATION:

District of Columbia
Maryland
Virginia
South Carolina
NCARB Certified

American Institute of Architects
AIA Northern Virginia Board
Member 2009-2015, Past
President 2014

Chair, AIA Northern Virginia
Design Awards Committee,
2009 – 2011

Presenter, Design DC 2015, 2016

Presenter, Architectural Exchange
East 2015, 2016

Board Member, Lee Highway
Alliance 2017-present

Member, Urban Design
Committee of Rosslyn BID
2015-2017

Panelist, DC Commission on the
Arts and Humanities, 2008

Guest Speaker and Studio Critic,
The Catholic University of
America, 2007 – 2010

Juror, Fairfax County Design
Excellence Awards
2009 and 2011

Juror, AIA California Central Valley
Design Awards, 2011

Experience

Scott Matties holds a Master of Architecture from the University of Michigan and has more than 30 years of experience in architectural design and master planning for award-winning institutional, academic, commercial, and residential projects. His career has encompassed all aspects of residential design including single-family additions, renovations, new homes, multi-family apartments and condominiums, both market rate and affordable, and mixed-use, mixed-income communities.

Continuing his vested interest in the education of communities concerning architecture and planning, Mr. Matties has led numerous community engagement meetings and presentations leading to approvals by jurisdictions throughout the Washington, DC Metropolitan area. He has extensive experience with community engagement and successfully managing projects with diverse stakeholder groups.

Mixed-Income Housing Experience:

- Mount Sterling Senior Housing, Sterling, Virginia ~ Affordable Housing
- 801 Rhode Island Ave NW, Washington, DC ~ Mixed-Income Housing
- Edgewood 5 Senior Housing, Washington, DC ~ Affordable Housing/Mixed-Use
- Spring Flats Senior Housing, Washington, DC ~ Affordable Housing
- Spring Flats Family Housing, Washington, DC ~ Mixed-Income Housing
- 125 35th Street Family Housing, Washington, DC ~ Affordable Housing

Masterplanning Experience:

- Meadow Green Master Plan, Washington, DC
- Spring Road Master Plan, Washington, DC
- North Hill Master Plan, Fairfax County, VA
- Buckingham Center Mixed-Use Revitalization, Arlington, VA
- University Drive Mixed-Use Master Plan, Fairfax County, VA

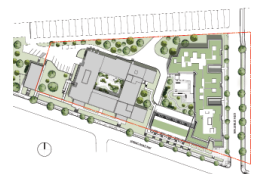

Wienczek + Associates Architects + Planners DC, LLP
1100 Vermont Avenue, NW
Eighth Floor
Washington, DC 20005
+1 202 349 0742

Design Empowering People.

wienczek-associates.com
ZONING COMMISSION
District of Columbia
CASE NO.66-68A
EXHIBIT NO.23B

Daniel Solomon, AICP, LEED AP ND

Project Manager, Transportation Planner

Mr. Solomon has significant transportation planning and engineering experience, including traffic impact studies, traffic simulation, field data collection and analysis, Transportation Demand Management (TDM), roadway signing and striping plans, bicycle planning and facilities design, parking studies, functional parking lot and garage design, and multi-modal planning efforts. Mr. Solomon has been involved with various types of projects including educational institutions, mixed-use developments, commercial and retail developments, office developments, and government facilities throughout the District of Columbia, Virginia, and Maryland. He takes great interest in the multi-modal component of urban projects that require innovative solutions to benefit all modes of transportation.

Daniel's project experience covers the full spectrum of land-use and includes:

Mixed-Use Development

1401 Pennsylvania Avenue SE Redevelopment, Washington, DC
301-331 N Street NE, Washington, DC
4001 South Capitol Street, Washington, DC
5 M Street SW, Washington, DC
680 Eye Street SW, Washington, DC
801 New Jersey Avenue NW, Washington, DC
965 Florida Avenue NW Development, Washington, DC
Bryant Street Development, Washington, DC
Hecht's Warehouse, Washington, DC
New City DC, Washington, DC
One M Street SE, Washington, DC
Stanton Square / Martha's Table PUD, Washington, DC
The Lady Bird PUD, Washington, DC
The Randall School Redevelopment, Washington, DC
The Wharf/SW Waterfront Redevelopment, Washington, DC
The Yards, Washington, DC
Union Market Transportation Impact Studies, Washington, DC
101 12th Street S, Arlington, VA
1900 Crystal Drive, Arlington, VA
2001 Richmond Highway, Arlington, VA
223 23rd Street/2300 Crystal Drive, Arlington, VA
2525 Crystal Drive, Arlington, VA
Northfax, City of Fairfax, VA
Tide Lock Development, Alexandria, VA
700 Quince Orchard Road Redevelopment, Gaithersburg, MD
Montgomery Village Shopping Center, Montgomery Village, MD

Multi-modal System Design / Planning

The Yards, Washington, DC
Union Station 2nd Century Master Plan, Washington, DC
DC2026 World Cup Bid Transportation Planning, Washington, DC



Education

Master of Science,
Environmental Studies, Tel Aviv
University, 2013

Bachelor of Arts, Environmental
Policy and Urban Planning,
York University, 2009

Professional Certifications

American Institute of Certified
Planners (AICP)

LEED NP Neighborhood
Development (ND)

Professional Associations

American Planning Association

Urban Land Institute (ULI)

ULI Regional Land Use
Leadership Institute Program
Committee

ULI Young Leaders Group
Education Committee

Young Professional Planners in
Washington DC

Experience

8 years total
6 years with Gorove Slade

Location

Washington, DC
Alexandria, VA

DDOT Livability Project Design, Washington, DC
DDOT Trip Generation Study, Washington, DC
DDOT K Street Transitway Study, Washington, DC
Sherman Avenue NW Streetscaping and Lane Reduction Study, Washington, DC
City of Alexandria Smart Mobility Framework, Alexandria, VA
City of Alexandria Cut-Through Mitigation Study, Alexandria, VA
Eisenhower East Small Area Plan Update, Alexandria, VA

Senior and Affordable Housing

801 Rhode Island Avenue NE, Washington, DC
Ingleside at Rock Creek, Washington, DC
Sunrise Senior Living, Washington, DC
Ward 4 Short-Term Family Housing, Washington, DC
Ward 5 Short-Term Family Housing, Washington, DC
Ward 6 Short-Term Family Housing, Washington, DC
Ward 7 Short-Term Family Housing, Washington, DC

Primary and Secondary Schools

DCPS Petworth Campus Transportation Plan, Washington, DC
Georgetown Day School, Washington, DC
KIPP DC Ferebee Hope, Washington, DC
KIPP DC Terrell School, Washington, DC
Latin-American Montessori Bilingual (LAMB) Public Charter School, Washington, DC
APS Career Center Site Expansion, Arlington, VA
APS Education Center Site Expansion, Arlington, VA
APS New Elementary School on Reed Site, Arlington, VA

Multi-Family Residential

10 Van Street SE, Washington, DC
1200 Varnum Street NE, Washington, DC
1315 Clifton Street Development, Washington, DC
15th & S Street NW, Washington, DC
1800 Columbia Road NW, Washington, DC
301 Florida NE, Washington, DC
57 N Street NW, Washington, DC
60 Eye Street SW, Washington, DC
Brookland Townhomes PUD, Washington, DC
Second and Fenwick, Silver Spring, MD
400 11th Street S, Arlington, VA

1401 Okie Street NE, Washington, DC
Bladensburg DaVita Dialysis BZA, Washington, DC
Department of Public Works Master Plan, Washington, DC
CVS Real Estate Projects, Washington, DC

Entertainment, Sports and Event Centers

Nationals Baseball Park Parking Study, Washington, DC
Kennedy Center for the Performing Arts, Washington, DC
RFK Stadium Campus Redevelopment, Washington, DC

Hotels

20 Massachusetts Avenue NW, Washington, DC
400 Florida Avenue NE, Washington, DC
The Yards Parcel L, Washington, DC

Commercial